

三爪自定心卡盤 (前後鎖通用)

SC 3 jaw scroll chuck(Front and back mounting)

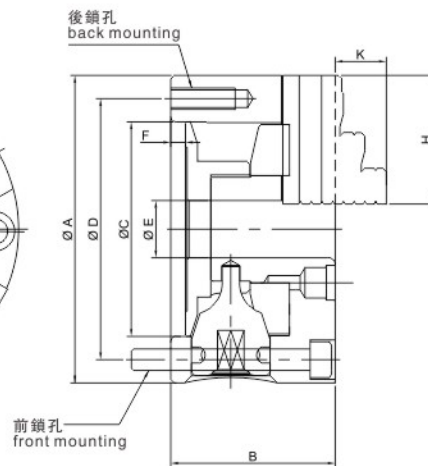

- 1.直口連接
 - 2.標配一體式正反爪各一組
 - 3.重複夾持精度為0.03mm
- 1.Plain back
 - 2.Standard accessories: 1 set outside solid jaws and 1 set inside solid jaws
 - 3.Clamping repeatability is 0.03mm

規格 / Specification

單位/UNIT:mm

型式/規格 Model/Spec	最大容許扭矩 Max. Allowable Torque N*m	最大靜夾持力 Max. Gripping Force KN	淨重 Weight Kg	最高轉速 RPM	夾持範圍外徑 O.D Clamping Range mm	夾持範圍內徑 I.D. Clamping Range mm
SC-03	29	9	1.5	2500	2-70	24-64
SC-04	44	12	3.1	2500	3-90	32-84
SC-05	63	15	4.4	2500	3-110	35-100
SC-06	88	31	11.4	2000	3-160	48-150
SC-07	107	31	12.2	2000	4-180	56-170
SC-08	128	33	16.2	2000	4-180	56-170
SC-09	147	37	21.2	2000	5-220	62-210
SC-10	176	46	28	1800	6-260	70-250
SC-12	206	55	41	1800	10-300	86-290
SC-14	225	55	54	1500	12-350	94-330
SC-16	245	60	74	1500	14-400	100-380

型式/規格 Model/Spec	A	B	C	D	E	F	G	H	J	K	L
SC-03	85	45	60	73	16	3.5	3-M6x1P	32	11	28	7
SC-04	112	58	80	95	24	4.5	3-M8x1.25P	42	15	31	8
SC-05	132	60	100	115	32	4.5	3-M8x1.25P	51	20	40	8
SC-06	167	66	130	147	45	5	3-M10x1.5P	70	20	53	10
SC-07	193	76	155	172	58	5	3-M10x1.5P	85	25	54	11
SC-08	203	76	160	176	58	5	3-M10x1.5P	85	25	54	11
SC-09	233	84	190	210	70	5.5	3-M12x1.75P	105	28	63	12
SC-10	273	86	230	250	89	5.5	3-M12x1.75P	105	28	63	12
SC-12	310	96	260	285	105	7	3-M12x1.75P	125	32	73	14
SC-14	355	112	300	328	127	7	6-M12x1.75P	125	32	73	15
SC-16	405	122	345	375	160	8	6-M14x2P	145	36	92	15

* 保留技術更改的權利，恕不另行通知 Subject to technology changes without prior information
 * 非標需求可訂做 Non-standard requirements can be made

