

- Standard accessories:
- 1 set of hard solid jaws
 - 1 safety wrench
 - 1 set of mounting screws.

标准配件:

- 1套卡爪
- 1个扳手
- 1套螺丝

K72 SERIES DIRECT MOUNTING TYPE A1/A2 FOUR-JAW INDEPENDENT CHUCKS

K72 系列四爪单动短锥卡盘 A1/A2 型

NTH

A2型穿孔螺钉连接
Form A2: Mounting with perforating screw

SPECIFICATIONS

UNIT: mm

Chuck Size	Short-taper No.	D1	D2	D3	H	H1	h	h1	h2	d1	z-d	Code No
200	4	63.513	82.6	56	110	75	13	10	6.5	14.7	4-M10	K72-200/A2-4
250	4	63.513	82.6	56	115.5	80	13	10	6.5	14.7	4-M10	K72-250/A2-4
200	5	82.563	104.8	56	110	75	15	12	6.5	16.3	4-M10	K72-200/A2-5
250	5	82.563	104.8	75	115.5	80	15	12	6.5	16.3	4-M10	K72-250/A2-5
320	5	82.563	104.8	75	134	90	15	12	6.5	16.3	4-M10	K72-320/A2-5
250	6	106.375	133.4	75	115.5	80	16	13	6.5	19.5	4-M12	K72-250/A2-6
320	6	106.375	133.4	75	134	90	16	13	6.5	19.5	4-M12	K72-320/A2-6
350	6	106.375	133.4	95	141	90	16	13	6.5	19.5	4-M12	K72-350/A2-6
400	6	106.375	133.4	95	143	95	16	13	6.5	19.5	4-M12	K72-400/A2-6
250	8	139.719	171.4	75	115.5	80	18	14	8.0	24.2	4-M16	K72-250/A2-8
320	8	139.719	171.4	95	134	90	18	14	8.0	24.2	4-M16	K72-320/A2-8
400	8	139.719	171.4	125	143	95	18	14	8.0	24.2	4-M16	K72-400/A2-8
450	8	139.719	171.4	125	147	100	18	14	8.0	24.2	4-M16	K72-450/A2-8
500	8	139.719	171.4	130	161	106	18	14	8.0	24.2	4-M16	K72-500/A2-8
630	8	139.719	171.4	130	180	115	18	14	8.0	24.2	4-M16	K72-630/A2-8
800	8	139.719	171.4	130	210	135	18	14	8.0	24.2	4-M16	K72-800/A2-8
400	11	196.869	235.0	160	143	95	20	16	10.0	29.4	4-M20	K72-400/A2-11
500	11	196.869	235.0	160	161	106	20	16	10.0	29.4	4-M20	K72-500/A2-11
630	11	196.869	235.0	180	180	115	20	16	10.0	29.4	4-M20	K72-630/A2-11
800	11	196.869	235.0	180	210	135	20	16	10.0	29.4	4-M20	K72-800/A2-11
1000	11	196.869	235.0	180	241	150	20	16	10.0	29.4	4-M20	K72-1000/A2-11
1250	11	196.869	235.0	180	256	165	20	16	10.0	29.4	4-M20	K72-1250/A2-11
630	15	285.775	330.2	241	180	115	21	17	10.0	35.7	4-M22	K72-630/A2-15
800	15	285.775	330.2	180	210	135	21	17	10.0	35.7	4-M22	K72-800/A2-15
1000	15	285.775	330.2	280	241	150	21	17	10.0	35.7	4-M22	K72-1000/A2-15
1000T	15	285.775	330.2	280	241	150	21	17	20.0	35.7	8-M20	K72-1000T/A2-15
1250T	15	285.775	330.2	280	256	165	21	17	20.0	35.7	8-M20	K72-1250T/A2-15
1250	15	285.775	330.2	280	256	165	21	17	20.0	35.7	8-M22	K72-1250/A2-15
1400D	15	285.775	330.2	280	246	155	21	17	20.0	35.7	8-M20	K72-1400D/A2-15
1600D	15	285.775	330.2	280	266	175	21	17	20.0	35.7	8-M20	K72-1600D/A2-15
2000	15	285.775	330.2	280	290	190	21	17	20.0	35.7	8-M20	K72-2000/A2-15
1000	20	412.775	463.6	305	241	150	23	19	10.0	42.1	8-M24	K72-1000/A2-20
1250	20	412.775	463.6	305	256	165	23	19	10.0	42.1	8-M24	K72-1250/A2-20
1600	20	412.775	463.6	305	266	175	23	19	10.0	42.1	8-M24	K72-1600/A2-20
2000	20	412.775	463.6	305	290	190	23	19	10.0	42.1	8-M24	K72-2000/A2-20

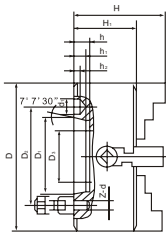

Standard accessories:

- 1 set of hard solid jaws
- 1 safety wrench
- 1 set of mounting screws.

标准配件:

- 1套卡爪
- 1个扳手
- 1套螺丝

NTH

K72 SERIES DIRECT MOUNTING
TYPE C FOUR-JAW INDEPENDENT CHUCKS

K72系列四爪单动短锥卡盘 C型

C型:拨盘、螺栓锁紧连接
Form C:Mounting with catch plate and locknuts

SPECIFICATIONS

UNIT: m

Chuck Size	Short-taper No.	D1	D2	D3	H	H1	h	h1	h2	d1	z-d	Code No
160	3	53.975	75.0	45	96.5	65	13	10	—	—	3-M10	K72-160/C3
160	4	63.513	85.0	56	96.5	65	13	10	6.5	14.7	3-M10	K72-160/C4
200	4	63.513	85.0	56	110	75	13	10	6.5	14.7	3-M10	K72-200/C4
250	4	63.513	85.0	56	115.5	80	13	10	6.5	14.7	3-M10	K72-250/C4
200	5	82.563	104.8	56	110	75	15	12	6.5	16.3	4-M10	K72-200/C5
250	5	82.563	104.8	56	115.5	80	15	12	6.5	16.3	4-M10	K72-250/C5
300	5	82.563	104.8	56	128.5	85	15	12	6.5	16.3	4-M10	K72-300/C5
320	5	82.563	104.8	56	134	90	15	12	6.5	16.3	4-M10	K72-320/C5
250	6	106.375	133.4	75	115.5	80	16	13	6.5	19.5	4-M12	K72-250/C6
300	6	106.375	133.4	75	128.5	85	16	13	6.5	19.5	4-M12	K72-300/C6
320	6	106.375	133.4	75	134	90	16	13	6.5	19.5	4-M12	K72-320/C6
350	6	106.375	133.4	75	141	90	16	13	6.5	19.5	4-M12	K72-350/C6
400	6	106.375	133.4	75	143	95	16	13	6.5	19.5	4-M12	K72-400/C6
500	6	106.375	133.4	75	161	106	16	13	6.5	19.5	4-M12	K72-500/C6
250	8	139.719	171.4	95	115.5	80	18	14	8.0	24.2	4-M16	K72-250/C8
320	8	139.719	171.4	95	134	90	18	14	8.0	24.2	4-M16	K72-320/C8
400	8	139.719	171.4	125	143	95	18	14	8.0	24.2	4-M16	K72-400/C8
500	8	139.719	171.4	125	161	106	18	14	8.0	24.2	4-M16	K72-500/C8
630	8	139.719	171.4	130	180	115	18	14	8.0	24.2	4-M16	K72-630/C8
400	11	196.869	235.0	160	143	95	20	16	10.0	29.4	6-M20	K72-400/C11
500	11	196.869	235.0	160	161	106	20	16	10.0	29.4	6-M20	K72-500/C11
630	11	196.869	235.0	180	180	115	20	16	10.0	29.4	6-M20	K72-630/C11
800	11	196.869	235.0	180	210	135	20	16	10.0	29.4	6-M20	K72-800/C11
1000	11	196.869	235.0	180	241	150	20	16	10.0	29.4	6-M20	K72-1000/C11
1250	11	196.869	235.0	180	256	165	20	16	10.0	29.4	6-M20	K72-1250/C11
630	15	285.775	330.2	180	180	115	21	17	10.0	35.7	6-M24	K72-630/C15
800	15	285.775	330.2	180	210	135	21	17	10.0	35.7	6-M24	K72-800/C15
1000	15	285.775	330.2	280	241	150	21	17	10.0	35.7	6-M24	K72-1000/C15
1250	15	285.775	330.2	280	256	165	21	17	10.0	35.7	6-M24	K72-1250/C15
1600	15	285.775	330.2	280	266	175	21	17	10.0	35.7	6-M24	K72-1600/C15

Standard accessories:

- 1 set of hard solid jaws
- 1 safety wrench
- 1 set of mounting screws.

标准配件:

- 1 套卡爪
- 1 个扳手
- 1 套螺丝

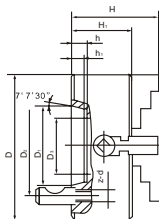

NTH

**K72 SERIES DIRECT MOUNTING
TYPE D FOUR-JAW INDEPENDENT CHUCKS**
K72 系列四爪单动短锥卡盘 D型

D型:拉杆、凸轮锁紧连接
Form D: Mounting with catch plate and locknuts

SPECIFICATIONS

UNIT: m

Chuck Size	Short-taper No.	D1	D2	D3	H	H1	h	h1	z-d	Code No
160	3	53.975	70.6	45	96.5	65	13	10	3-M10×1	K72-160/D3
160	4	63.513	82.6	56	96.5	65	13	10	3-M10×1	K72-160/D3
200	4	63.513	82.6	56	110	75	13	10	3-M10×1	K72-200/D4
250	4	63.513	82.6	56	115.5	80	13	10	3-M10×1	K72-250/D4
200	5	82.563	104.8	56	110	75	15	12	6-M12×1	K72-200/D5
250	5	82.563	104.8	56	115.5	80	15	12	6-M12×1	K72-250/D5
300	5	82.563	104.8	56	128.5	85	15	12	6-M12×1	K72-300/D5
320	5	82.563	104.8	56	134	90	15	12	6-M12×1	K72-320/D5
250	6	106.375	133.4	75	115.5	80	16	13	6-M16×1.5	K72-250/D6
300	6	106.375	133.4	75	128.5	85	16	13	6-M16×1.5	K72-300/D6
320	6	106.375	133.4	75	134	90	16	13	6-M16×1.5	K72-320/D6
350	6	106.375	133.4	75	141	90	16	13	6-M16×1.5	K72-350/D6
400	6	106.375	133.4	75	143	95	16	13	6-M16×1.5	K72-400/D6
320	8	139.719	171.4	95	134	90	18	14	6-M20×1.5	K72-320/D8
350	8	139.719	171.4	95	141	90	18	14	6-M20×1.5	K72-350/D8
400	8	139.719	171.4	125	143	95	18	14	6-M20×1.5	K72-400/D8
450	8	139.719	171.4	125	147	100	18	14	6-M20×1.5	K72-450/D8
500	8	139.719	171.4	125	161	106	18	14	6-M20×1.5	K72-500/D8
400	11	196.689	235.0	160	143	95	20	16	6-M22×1.5	K72-400/D11
500	11	196.689	235.0	160	161	106	20	16	6-M22×1.5	K72-500/D11
630	11	196.689	235.0	180	180	115	20	16	6-M22×1.5	K72-630/D11
800	11	196.689	235.0	180	210	135	20	16	6-M22×1.5	K72-800/D11
1000	11	196.689	235.0	180	241	150	20	16	6-M22×1.5	K72-1000/D11
630	15	285.775	330.2	180	180	115	21	17	6-M24×1.5	K72-630/D15
800	15	285.775	330.2	180	210	135	21	17	6-M24×1.5	K72-800/D15
1000	15	285.775	330.2	280	241	150	21	17	6-M24×1.5	K72-1000/D15
1250	15	285.775	330.2	280	256	165	21	17	6-M24×1.5	K72-1250/D15
1600	15	285.775	330.2	280	266	175	21	17	6-M24×1.5	K72-1600/D15