

M 手動卡盤系列

MANUAL CHUCK SERIES



普通型三爪夾頭

SC 3-JAW SCROLL CHUCKS

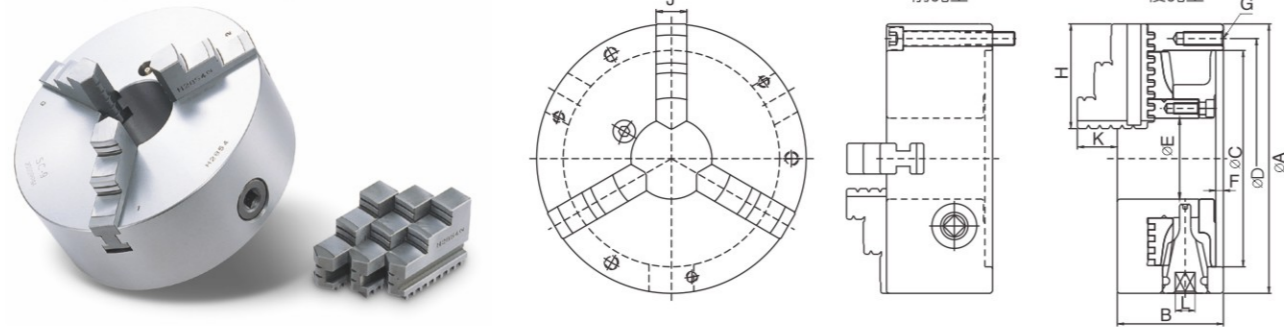

規格 / Specification

型式 / 規格 MODEL / SPEC.	A	B	C	D	E	F	G	H	J	K	L	最高迴轉速 Max.Speed r.p.m.(min ⁻¹)	把握範圍 Max. Gripping Diameter		淨重 Weight (kg)
													外徑把握 O.D.Clamping	內徑把握 I.D.Clamping	
SC-03	85	45	60	73	16	3.5	3-M6x1P	35	11	15	7	2500	Ø2-Ø70	Ø24-Ø64	1.5
SC-04	112	58	80	95	24	4.5	3-M8x1.25P	42	14	17	8	2500	Ø3-Ø90	Ø32-Ø84	3.3
SC-05	132	60	100	115	32	4.5	3-M8x1.25P	50	16	20	8	2500	Ø3-Ø110	Ø35-Ø100	4.6
SC-06	167	66	130	147	45	5	3-M10x1.5P	65	19	23	10	2000	Ø4-Ø160	Ø48-Ø150	7.9
SC-07	193	76	155	172	58	5	3-M10x1.5P	75	22	28	11	2000	Ø4-Ø180	Ø56-Ø170	12.0
SC-08	203	76	160	176	58	5	3-M10x1.5P	75	22	28	11	2000	Ø4-Ø180	Ø56-Ø170	13.3
SC-09	233	84	190	210	70	5.5	3-M12x1.75P	85	24	34.5	12	2000	Ø5-Ø220	Ø62-Ø210	19.3
SC-10	273	86	230	250	89	5.5	3-M12x1.75P	98	28	39	12	1800	Ø6-Ø260	Ø70-Ø250	26.2
SC-12	310	96	260	285	105	7	3-M12x1.75P	110	30	45	14	1800	Ø10-Ø300	Ø86-Ø290	37.6
SC-14	355	112	300	328	127	7	6-M12x1.75P	132	35	50	15	1500	Ø12-Ø350	Ø96-Ø320	57.2
SC-16	405	122	345	375	160	8	6-M14x2P	146	40	56	15	1500	Ø14-Ø400	Ø100-Ø380	80.7

單位/UNIT:mm

錐型六爪夾頭

AS 6-JAW AWL TYPE CHUCKS

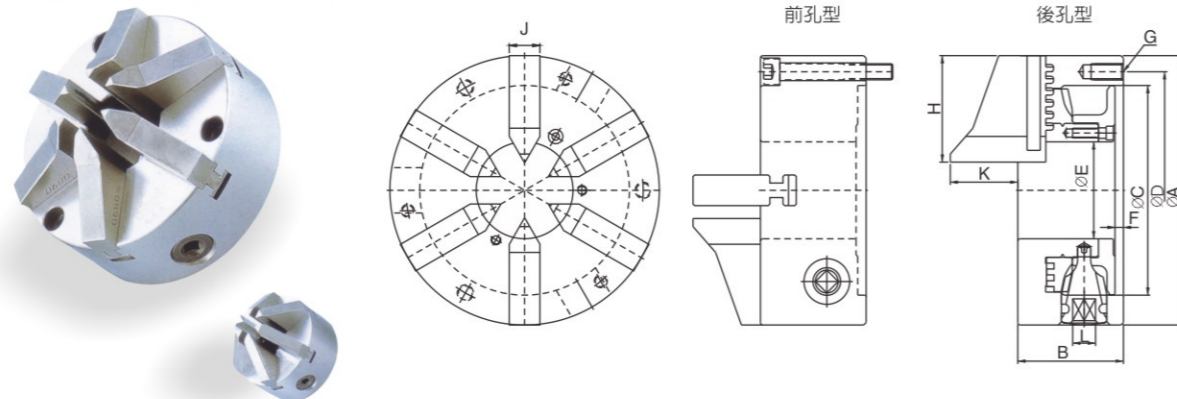

規格 / Specification

型式 / 規格 MODEL / SPEC.	A	B	C	D	E	F	G	H	J	K	L	最高迴轉速 Max.Speed r.p.m.(min ⁻¹)	把握範圍 Max. Gripping Diameter		淨重 Weight (kg)
													外徑把握 O.D.Clamping	內徑把握 I.D.Clamping	
AS-04	112	58	80	95	32	4.5	3-M8x1.25P	45	14	46	8	1200	Ø2-Ø32	Ø3-Ø60	3.8
AS-06	167	65	130	147	60	5.0	3-M10x1.5P	66	19	43	10	1200	Ø3-Ø60	Ø3-Ø60	8.2

單位/UNIT:mm

PSK強力連動型四爪夾頭

PSK 4-JAW POWERFUL TYPE SCROLL CHUCKS

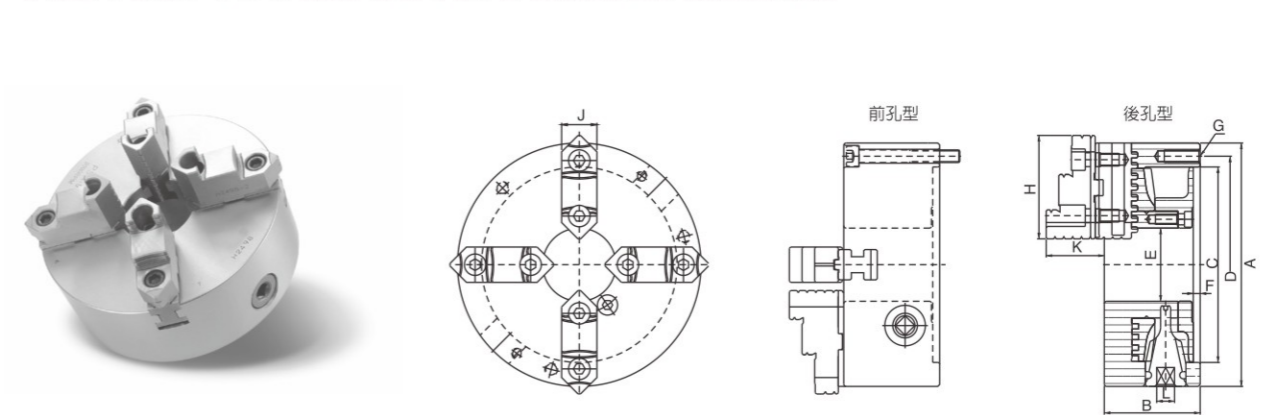

規格 / Specification

型式 / 規格 MODEL / SPEC.	A	B	C	D	E	F	G	H	J	K	L	淨重 Weight (kg)	最高迴轉速 Max.Speed r.p.m.(min ⁻¹)	把握範圍 Max. Gripping Diameter	
														外徑把握 O.D.Clamping	內徑把握 I.D.Clamping
PSK-07	193	76	155	172	58	5	3-M10x1.5P	82	28	43	11	12.7	2000	Ø8-Ø180	Ø62-Ø170
PSK-09	233	84	190	210	70	6	3-M12x1.75P	93	32	50	12	20.8	2000	Ø11-Ø220	Ø70-Ø210
PSK-12	310	96	260	285	105	7	3-M12x1.75P	118	40	56	14	43	1800	Ø15-Ø300	Ø90-Ø290
PSK-16	405	122	345	375	160	8.5	6-M14x2P	150	50	75	15	86.7	1500	Ø30-Ø400	Ø110-Ø380
PSK-20	500	140	420	458	205	5.5	6-M14x2P	140	55	84	19	149	1000	Ø25-Ø480	Ø125-Ø460

單位/UNIT:mm

直裝型三爪夾頭

D1 3-JAW D1 TYPE CHUCKS

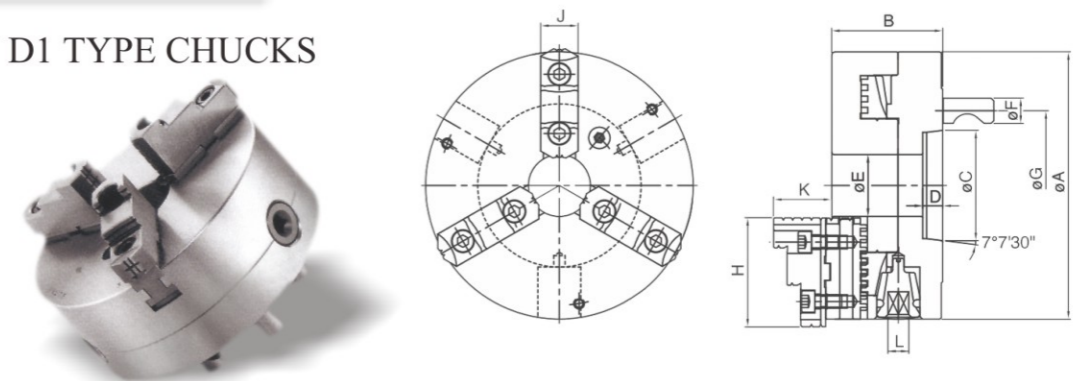

規格 / Specification

型式 / 規格 MODEL / SPEC.	A	B	C	D	E	F	G	H	J	K	L	最高迴轉速 Max.Speed r.p.m.(min ⁻¹)	把握範圍 Max. Gripping Diameter		淨重 Weight (kg)
													外徑把握 O.D.Clamping	內徑把握 I.D.Clamping	
D,5-08"	200	83	82.563	15	46	19	104.8	82	28	43	11	2000	Ø8-Ø180	Ø62-Ø170	17.8
D,6-08"	200	83	106.375	16	58	22.2	133.4	82	28	43	11	2000	Ø8-Ø180	Ø62-Ø170	17.3
D,6-10"	255	94	106.375	16	76	22.2	133.4	93	32	50	12	1800	Ø11-Ø240	Ø70-Ø230	31.3
D,8-10"	255	94	139.719	18	76	25.4	171.4	93	32	50	12	1800	Ø11-Ø240	Ø70-Ø230	30.9
D,8-12"	310	105	139.719	18	103	25.4	171.4	118	40	56	14	1800	Ø15-Ø300	Ø90-Ø290	51.1
D,11-20"	500	135	196.869	-	190.5	30.2	235	140	55	84	19	1000	Ø25-Ø480	Ø125-Ø460	165.5

單位/UNIT:mm

連動型四爪夾頭

PS 4-JAW SCROLL CHUCKS

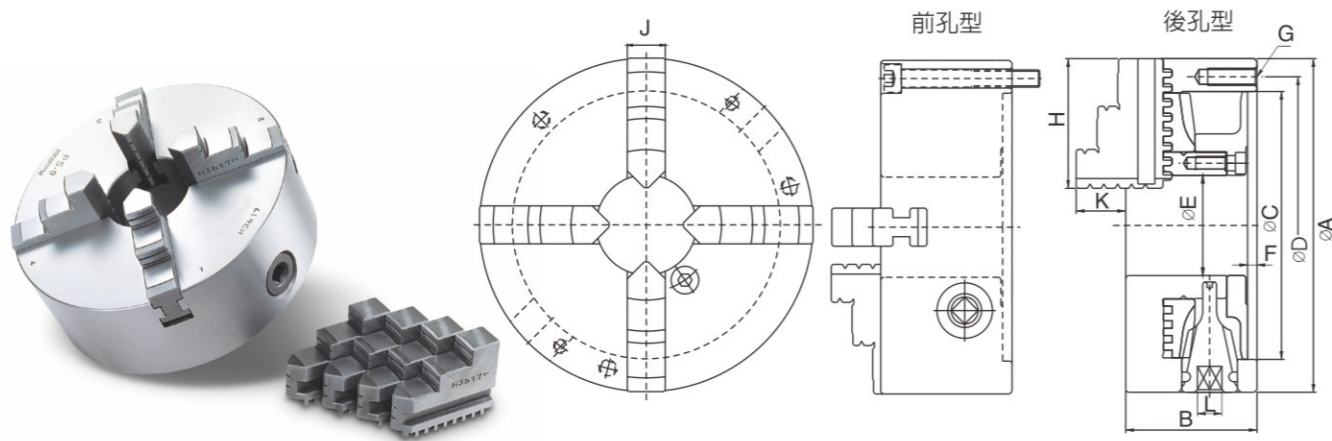

規格 / Specification

型式 / 規格 MODEL/SPEC.	A	B	C	D	E	F	G	H	J	K	L	最高迴轉速 Max.Speed r.p.m.(min ⁻¹)	把握範圍 Max. Gripping Diameter		淨重 Weight (kg)
													外徑把握 O.D.Clamping	內徑把握 I.D.Clamping	
PS-07	193	76	155	172	58	5	3-M10x1.5P	75	22	28	11	2000	ø4-ø180	ø56-ø170	12.1
PS-09	233	84	190	210	70	5.5	3-M12x1.75P	85	24	34.5	12	2000	ø5-ø220	ø62-ø210	19.4
PS-12	310	96	260	285	105	7	3-M12x1.75P	110	30	45	14	1800	ø10-ø300	ø86-ø290	38.1
PS-16	405	122	345	375	160	8	6-M14x2P	146	40	56	15	1500	ø14-ø400	ø100-ø380	82.4

單位/UNIT:mm

錐型八爪夾頭

AE 8-JAW AWL TYPE CHUCKS

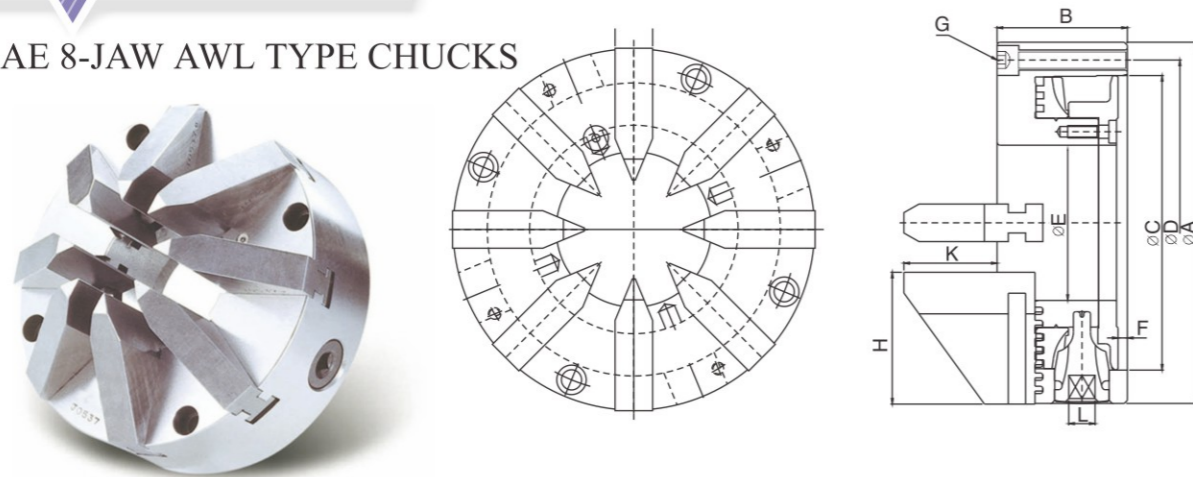

規格 / Specification

型式 / 規格 MODEL/SPEC.	A	B	C	D	E	F	G	H	J	K	L	最高迴轉速 Max.Speed r.p.m.(min ⁻¹)	把握範圍 Max. Gripping Diameter		淨重 Weight (kg)
													外徑把握 O.D.Clamping	內徑把握 I.D.Clamping	
AE-09	233	84	190	210	100	5.5	4-M12x1.75P	85	24	60	12	1000	ø7-ø100		21

單位/UNIT:mm

強力型三爪夾頭

SK 3-JAW POWERFUL TYPE SCROLL CHUCKS

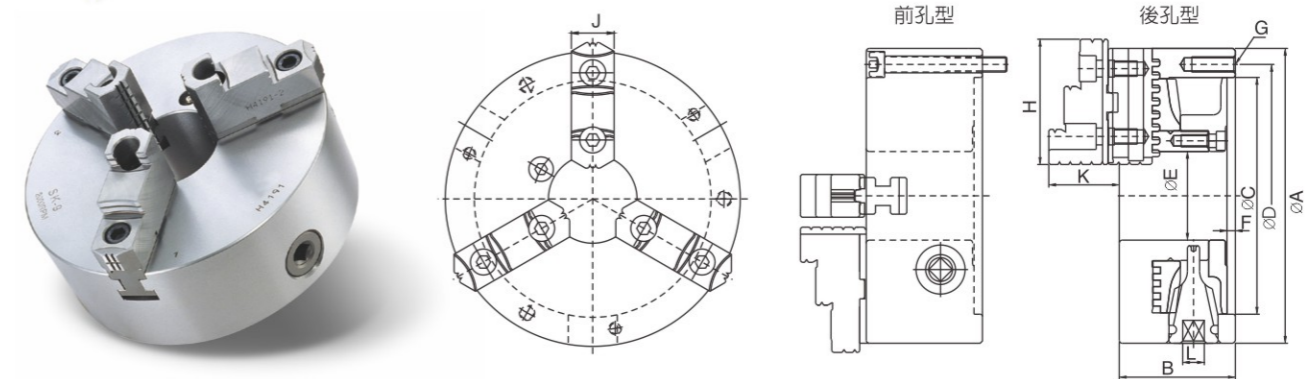

型式 / 規格 MODEL/SPEC.	A	B	C	D	E	F	G	H	J	K	L	最高迴轉速 Max.Speed r.p.m.(min ⁻¹)	把握範圍 Max. Gripping Diameter		淨重 Weight (kg)
													外徑把握 O.D.Clamping	內徑把握 I.D.Clamping	
SK-04	112	58	80	95	24	4.5	3-M8x1.25P	47	19	31.5	8	2500	ø3-ø100	ø35-ø93	3.45
SK-05	132	60	100	115	32	4.5	3-M8x1.25P	57	24	36	8	2500	ø3-ø123	ø43-ø122	5.0
SK-06	167	66	130	147	45	5	3-M10x1.5P	68	26	39	10	2000	ø8-ø160	ø55-ø150	8.6
SK-07	193	76	155	172	58	5	3-M10x1.5P	82	28	43	11	2000	ø8-ø180	ø62-ø170	12.8
SK-08	203	76	160	176	58	5	3-M10x1.5P	82	28	43	11	2000	ø8-ø180	ø62-ø170	14.1
SK-09	233	84	190	210	70	5.5	3-M12x1.75P	93	32	50	12	2000	ø11-ø220	ø70-ø210	20.4
SK-10	273	86	230	250	89	5.5	3-M12x1.75P	102	32	54.5	12	1800	ø12-ø260	ø80-ø250	26.7
SK-12	310	96	260	285	105	7	3-M12x1.75P	118	40	56	14	1800	ø15-ø300	ø90-ø290	39.3
SK-14	355	122	300	328	127	7	6-M12x1.75P	139	45	70.5	15	1500	ø25-ø350	ø110-ø320	60.7
SK-16	405	122	345	375	160	8	6-M14x2P	150	50	75	15	1500	ø30-ø400	ø110-ø380	82.3
SK-20	500	140	420	458	205	5.5	6-M16x2P	140	55	84	19	1000	ø25-ø480	ø125-ø460	145.
SK-25	630	140	545	586	275	6.5	6-M16x2P	140	70	92	19	850	ø80-ø630	ø198-ø601	221.3
SKB-25	630	140	545	586	320	6.5	6-M16x2P	140	70	92	19	850	ø160-ø630	ø274-ø646	208.5

直裝型三爪夾頭

A1(A2) 3-JAW A1(A2) TYPE CHUCKS

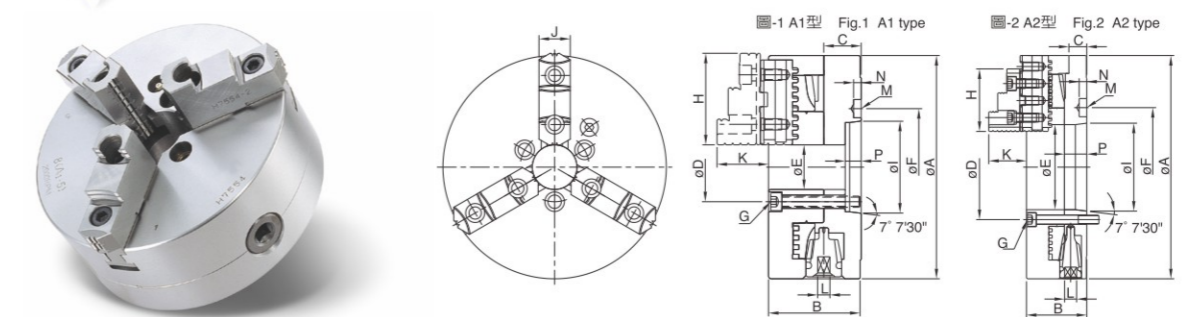

規格 / Specification

型式 / 規格 MODEL/SPEC.	A	B	C	D	E	F	G	H	I	J	K	L	P	M	N	最高迴轉速 Max.Speed r.p.m.(min ⁻¹)	把握範圍 Max. Gripping Diameter		淨重 Weight (kg)
																	外徑把握 O.D.Clamping	內徑把握 I.D.Clamping	
A ₁ -5-08"	200	83	33.5	61.9	40	ø104.8	3-M10x1.5P	82	82.563	28	43	11	14.29	ø16.3	6.8	2000	ø8-ø180	ø62-ø170	17.4
A ₁ -6-08"	200	83	33.5	82.6	56	ø133.4	3-M12x1.75P	82	106.375	28	43	11	15.88	ø19.3	6.8	2000	ø8-ø180	ø62-ø170	18
A ₁ -6-10"	255	91.5	36.5	82.6	56	ø133.4	3-M12x1.75P	93	106.375	32	50	12	15.88	ø19.3	6.8	1800	ø11-ø240	ø70-ø230	30.6
A ₂ -11-20"	500	135	40	235	190.5	ø235	6-M20x2.5P	140	196.869	55	84	19	-	ø29.4	10.7	1000	ø25-ø480	ø125-ø460	161.5

單位/UNIT:mm

強力超薄型夾盤

NBK POWERFUL TYPE SUPER THIN CHUCKS

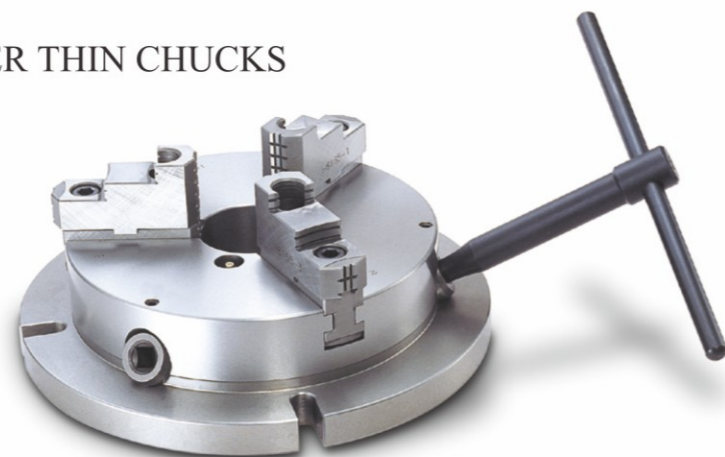

強力超薄型夾盤之特色：

- ◎ 1.把手和盤面成30°角，旋轉操作更便利。
- ◎ 2.薄型設計，可增加機械加工之容許長度。
- ◎ 3.外徑成凸緣設計，裝卸容易。
- ◎ 4.強力型設計可共用生爪。

SUPER THIN CHUCKS

- ◎ 1.The handle with an angle of 30 degrees is much convenient for operations.
- ◎ 2.The "super thin thickness" design of chucks increase the "allowable distance" of machining operations.
- ◎ 3.Chuck flange makes loading and unloading operations simpler and more convenient.
- ◎ 4.Hard jaws and Soft jaws can be used alternatively.

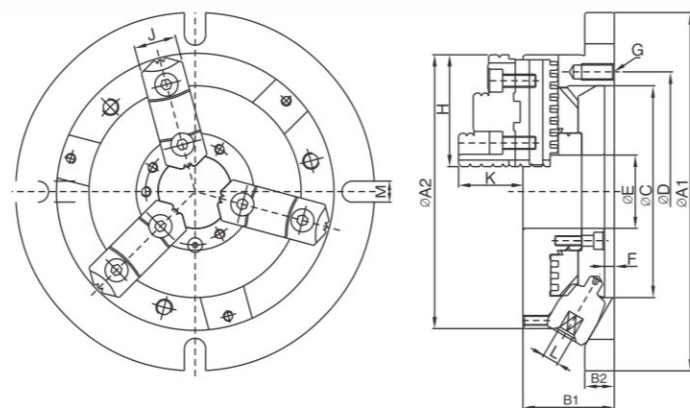

尺寸圖 / DIMENSIONS

規格 / Specification

單位/UNIT:mm

型式 / 規格 MODEL/SPEC.	A1	A2	B1	B2	C	D	E	F	G	H
NBK-06	220	170	58	18	130	147	45	6	3-M10x1.5P	68
NBK-08	270	210	65	20	155	172	60	6	3-M10x1.5P	82
NBK-10	315	255	73	20	190	210	80	6	3-M12x1.75P	93
NBK-12	370	305	80	22	250	285	105	5	3-M12x1.75P	118

型式 / 規格 MODEL/SPEC.	J	K	L	M	把握範圍 Max. Gripping Diameter		淨重 Weight (kg)
					外徑把握 O.D. Clamping (mm)	內徑把握 I.D. Clamping (mm)	
NBK-06	26	40	10	13	ø8~ø160	ø48~ø150	10.6
NBK-08	28	43	11	13	ø11~ø200	ø62~ø190	18.1
NBK-10	32	52	12	16	ø12~ø250	ø72~ø240	27.9
NBK-12	40	59	14	18	ø15~ø300	ø86~ø290	42.9

方型超薄夾盤

MC SUPER THIN SUARE CHUCKS

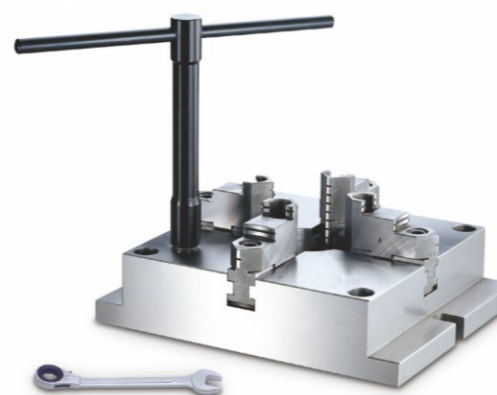

使用範例 OPERATION EXAMPLE



MC 附硬爪

- ◎ 1.MC均為定寸研磨方式；任何相同規格之方型夾盤W,X,Y,Z各點之高度公差為0.05mm以內。
- ◎ 2.MC規格均可替換生爪，作不規則形狀之加工，以替代中心機大量治具，更經濟、方便。
- ◎ 3.硬爪重複夾持之精度公差為0.02mm以內。
- ◎ 4.側邊平行校正後，硬爪夾持之平行公差為0.05mm以內。

MC SQUARE SHUCKS

- ◎ 1.MC chucks are precisely ground, the tolerances of W,X,Y,Z among chucks are with in 0.05mm.
- ◎ 2.Soft jaws can be used alternatively for machining special shaped work pieces, to substitute for designing and making a lot of jigs for this purpose.
- ◎ 3.The repetitive gripping accuracy with the hard jaws are with in 0.02mm.
- ◎ 4.Parallel gripping accuracy with hard jaws can be controlled with in 0.05mm after aligning sides of chucks.

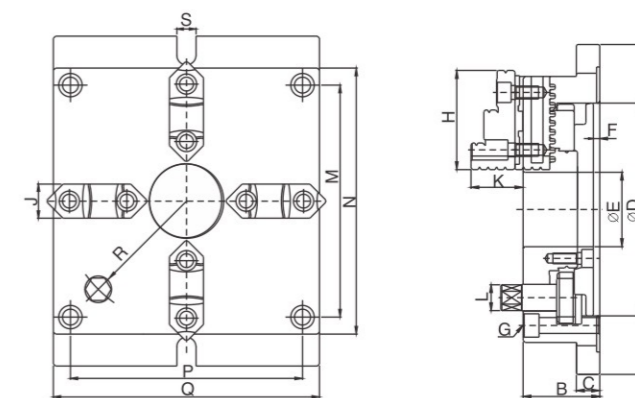

尺寸圖 / DIMENSIONS

規格 / Specification

單位/UNIT:mm

型式 / 規格 MODEL/SPEC.	A	B	C	D	E	F	G	H	J	K	L
MC-06	215	57	18	130	40	5.5	4-M10x1.5P	68	26	39	14
MC-08	250	65	20	160	55	6	4-M12x1.75P	82	28	43	17
MC-10	310	72	22	200	70	6	4-M14x2P	93	32	50	21
MC-12	380	85	25	260	100	7	4-M16x2P	118	40	56	23

型式 / 規格 MODEL/SPEC.	M	N	P	Q	R	S	把握範圍 Max. Gripping Diameter		淨重 Weight (kg)
							外徑把握 O.D. Clamping	內徑把握 I.D. Clamping	
MC-06	144	165	144	165	66	18	ø4-ø128	ø55-ø128	11.4
MC-08	174	200	174	200	83	18	ø5-ø162	ø62-ø162	18.6
MC-10	218	250	218	250	104	18	ø6-ø200	ø72-ø200	31.6
MC-12	274	310	274	310	135	22	ø10-ø265	ø90-ø265	56.6

方型夾盤於 W, X, Y, Z 各點圖示

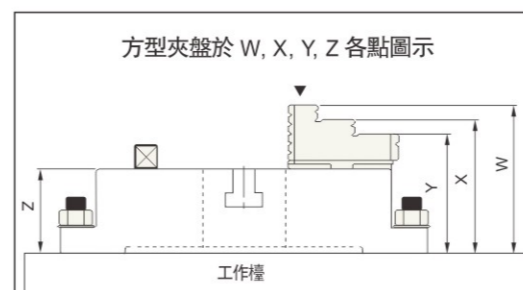

超薄型夾盤

SE SUPER THIN CHUCKS

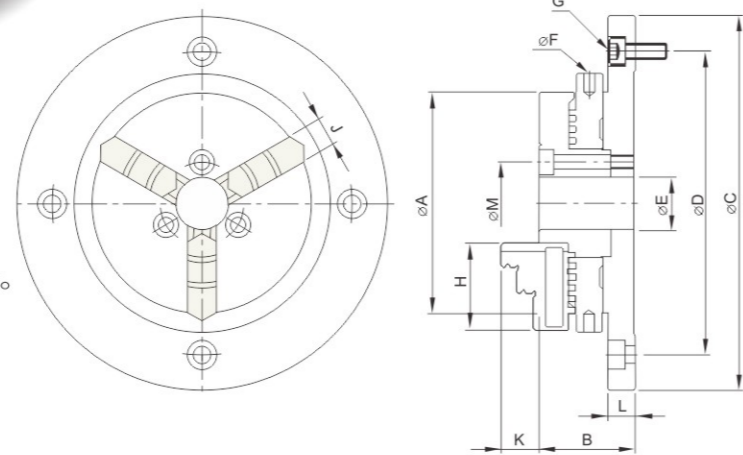

尺寸圖 / DIMENSIONS

超薄型夾盤之特色：

- ◎ 1.輕、薄、短小的設計，適用於工件量測夾持。
- ◎ 2.直接轉動旋盤，免於使用板手旋轉干涉。
- ◎ 3.鋼製本體，耐用性甚佳。
- ◎ 4.夾爪正反夾持兩用設計，操作方便。
- ◎ 5. 2 " 最小工件夾持0.8mm。

SUPER THIN CHUCKS

- ◎ 1. By the compactness comes from "Light, Thin, Short, Small" design concept; the chucks are most fitting to hold work pieces for measuring.
- ◎ 2. Just rotate the chuck knob directly for gripping and loosening, a handle is not necessary to be used.
- ◎ 3. Chuck body is made of very durable steel.
- ◎ 4. Jaws can be reversibly used; gripping of various sizes becomes much convenient.
- ◎ 5. 2" chucks can even grip up to the smallest size of 0.08mm

規格 / Specification

單位/UNIT:mm

型式 / 規格 MODEL/SPEC.	A	B	C	D	E	F	G	H
SE-02	63	28	118	100	16	4	4-M5x0.8P	27
SE-03	85	37	143	116	20	4	4-M6x1P	35
SE-04	110	39	168	140	26	5	4-M6x1P	42
SE-05	130	45	202	168	32	6	4-M8x1.25P	50
SE-06	160	52	248	208	50	8	4-M10x1.5P	65

型式 / 規格 MODEL/SPEC.	J	K	L	M	把握範圍 Max. Gripping Diameter		淨重 Weight (kg)
					外徑把握 O.D.Clamping	內徑把握 I.D.Clamping	
SE-02	8	13	8	26	ø0.8~ø63	ø23~ø58	1.2
SE-03	11	15	10.5	32	ø1~ø81	ø31~ø70	2.9
SE-04	14	19	10	40	ø1~ø100	ø36~ø90	4.3
SE-05	16	21	11.5	49	ø1.5~ø116	ø43~ø106	6.2
SE-06	19	26	15	70	ø1.5~ø160	ø52~ø148	11.1

齒式二爪鋼殼夾頭

TNT 2-JAW STEEL BODY CHUCKS

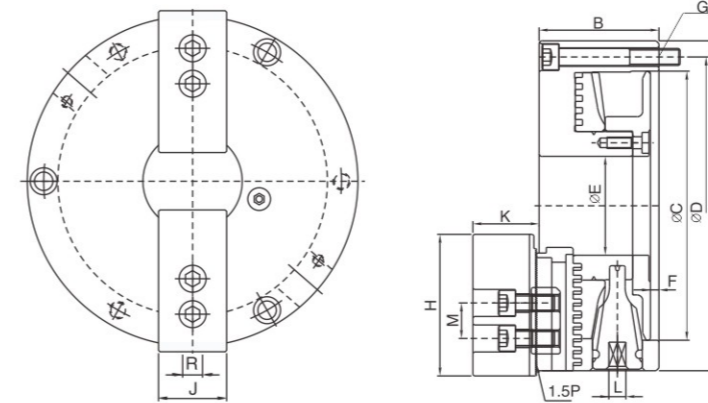

尺寸圖 / DIMENSIONS

規格 / Specification

單位/UNIT:mm

型式 / 規格 MODEL/SPEC.	A	B	C	D	E	F	G	H	J	K	L
TNT-07	193	78	155	172	58	5	3-M10x1.5P	73	31	38	11
TNT-09	233	85	190	210	70	5.5	3-M12x1.75P	95	35	40	12

型式 / 規格 MODEL/SPEC.	M	R	最高轉速 Max. Speed r.p.m.(min ⁻¹)	把握範圍 Max. Gripping Diameter		淨重 Weight (kg)
				外徑把握 O.D.Clamping	內徑把握 I.D.Clamping	
TNT-07	20	12	3200	ø8~ø235	ø66~ø235	14.4
TNT-09	25	14	2800	ø11~ø280	ø85~ø280	22.3

齒式鋼殼夾盤特色：

- ◎ 1.可替代修整油壓生爪成型盤。
- ◎ 2.爪仔可前後任意調整，加大夾持工件範圍。
- ◎ 3.生爪及硬爪與CNC車床油壓爪共用。
- ◎ 4.鋼殼結構於高速迴轉時安全性高，耐磨性強，使用壽命長。
- ◎ 5.轉動板手扭力較小操作順暢。

Steel body chucks:

- ◎ 1.Can be used as a " Forming plate " for machining soft jaws.
- ◎ 2.Hard jaws and soft jaws can be adjusted just like on a power Chuck to increase the gripping range.
- ◎ 3.Hard jaws as well as Soft jaws are interchangeable with those of power chucks.
- ◎ 4.Chuck Body is made of steel to enhance safety operations for high speed machining.
- ◎ 5.The Chuck Handle can be operated easily and smoothly.

特點配合圖示說明 / ILLUSTRATE :



可替代修整油壓生爪成型盤

The chuck can be used as a " Forming plate " for machining soft jaws.



爪仔可前後任意調整加大夾持工件範圍

Top jaws can be adjusted back and forth easily, thus increasing gripping range.

齒式三爪鋼殼夾頭

NT 3-JAW STEEL BODY CHUCKS

齒式鋼殼夾盤特色：

- 1. 可替代修整油壓生爪成型盤。
- 2. 爪仔可前後任意調整，加大夾持工件範圍。
- 3. 生爪及硬爪與CNC車床油壓爪共用。
- 4. 鋼殼結構於高速迴轉時安全性高，耐磨性強，使用壽命長。
- 5. 轉動板手扭力較小操作順暢。

Steel body chucks:

- 1. Can be used as a "Forming plate" for machining soft jaws.
- 2. Hard jaws and soft jaws can be adjusted just like on a power Chuck to increase the gripping range.
- 3. Hard jaws as well as Soft jaws are interchangeable with those of power chucks.
- 4. Chuck Body is made of steel to enhance safety operations for high speed machining.
- 5. The Chuck Handle can be operated easily and smoothly.

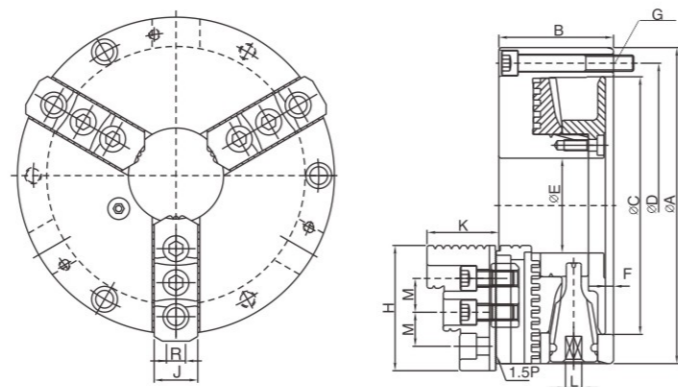

特點配合圖示說明 / ILLUSTRATE :



硬爪與油壓夾盤硬爪共用

Hard jaws are interchangeable with those of power chucks.



生爪與油壓夾盤生爪共用

連結盤

Soft jaws are interchangeable with those of power chucks. Optional accessory: Mounting plate.

規格 / Specification

單位/UNIT:mm

型式 / 規格 MODEL/SPEC.	A	B	C	D	E	F	G	H	J	K	L	最高轉速 Max. Speed r.p.m. (min ⁻¹)		把握範圍 Max. Gripping Diameter		淨重 Weight (kg)
												外徑把握 O.D. Clamping	內徑把握 I.D. Clamping			
NT-07	193	78	155	172	58	5	3-M10x1.5P	78	28	46	11	3200	2800	ø8~ø235	ø66~ø235	13.1
NT-09	233	85	190	210	70	5.5	3-M12x1.75P	92	32	52	12	2800	2400	ø11~ø280	ø85~ø280	21.2
NT-10	273	91	230	250	89	5.5	3-M12x1.75P	101.5	37	56	12	2400	2100	ø12~ø330	ø92~ø330	30.5
NT-12	310	104	260	285	105	7	3-M12x1.75P	116	47	67	14	2100	2100	ø15~ø370	ø104~ø370	46.1

型式 / 規格 MODEL/SPEC.	M	R	最高轉速 Max. Speed r.p.m. (min ⁻¹)	把握範圍 Max. Gripping Diameter		淨重 Weight (kg)
				外徑把握 O.D. Clamping	內徑把握 I.D. Clamping	
NT-07	20	12	3200	ø8~ø235	ø66~ø235	13.1
NT-09	25	14	2800	ø11~ø280	ø85~ø280	21.2
NT-10	30	16	2400	ø12~ø330	ø92~ø330	30.5
NT-12	30	21	2100	ø15~ø370	ø104~ø370	46.1

普通型三爪可調式鋼殼夾頭

CT 3-JAW ADJUSTMENT STEEL BODY SCROLL CHUCKS

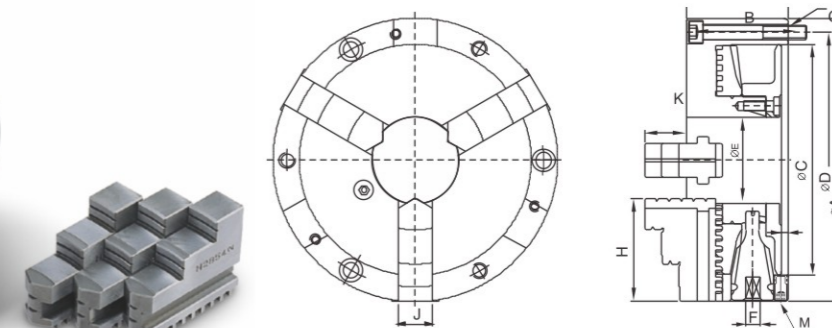

規格 / Specification

單位/UNIT:mm

型式 / 規格 MODEL/SPEC.	A	B	C	D	E	F	G	H	J	K	L	M	最高轉速 Max. Speed r.p.m. (min ⁻¹)	把握範圍 Max. Gripping Diameter		淨重 Weight (kg)
														外徑把握 O.D. Clamping	內徑把握 I.D. Clamping	
CT-06	167	75.5	130	147	45	12	3-M10x1.5P	65	22	28	10	4-M10x1.5P	4000	ø4-ø160	ø48-ø150	10.4
CT-07	193	85	155	172	58	12	3-M10x1.5P	75	24	28.5	11	4-M10x1.5P	3500	ø4-ø180	ø56-ø170	12.9
CT-09	233	92	190	210	70	12.5	3-M12x1.75P	85	28	33	12	4-M10x1.5P	2900	ø5-ø220	ø62-ø210	20.4
CT-10	275	98	230	250	89	12.5	3-M12x1.75P	98	30	38	12	4-M10x1.5P	2500	ø6-ø260	ø70-ø250	29.3
CT-12	310	111	260	285	105	14	3-M12x1.75P	110	32	45	14	4-M12x1.75P	2200	ø10-ø300	ø86-ø290	43.7

普通型四爪可調式鋼殼夾頭

FCT 4-JAW ADJUSTMENT STEEL BODY SCROLL CHUCKS

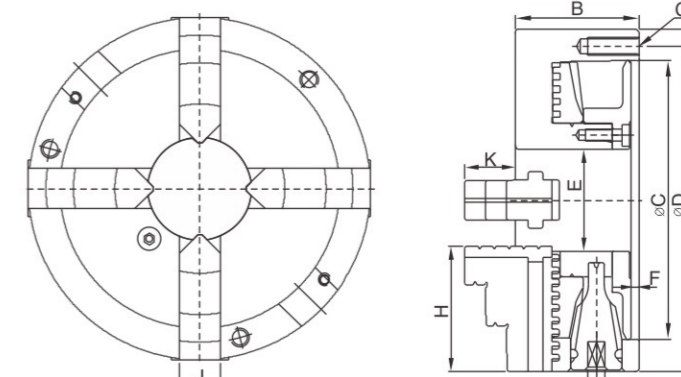

規格 / Specification

單位/UNIT:mm

型式 / 規格 MODEL/SPEC.	A	B	C	D	E	F	G	H	J	K	L	M	最高轉速 Max. Speed r.p.m. (min ⁻¹)	把握範圍 Max. Gripping Diameter		淨重 Weight (kg)
														外徑把握 O.D. Clamping	內徑把握 I.D. Clamping	
FCT-07	193	85	155	172	58	12	3-M10x1.5P	75	24	28.5	11	4-M10x1.5P	3500	ø4-ø180	ø56-ø170	13.2
FCT-09	233	92	190	210	70	12.5	3-M12x1.75P	85	28	33	12	4-M10x1.5P	2900	ø5-ø220	ø62-ø210	20.7
FCT-10	275	98	230	250	89	12.5	3-M12x1.75P	98	30	38	12	4-M10x1.5P	2500	ø6-ø260	ø70-ø250	29.8
FCT-12	310	111	260	285	105	14	3-M12x1.75P	110	32	45	14	4-M12x1.75P	2200	ø10-ø300	ø86-ø290	44.4

強力型二爪可調式鋼殼夾頭

TKT 2-JAW POWERFUL TYPE ADJUSTMENT STEEL BODY CHUCKS

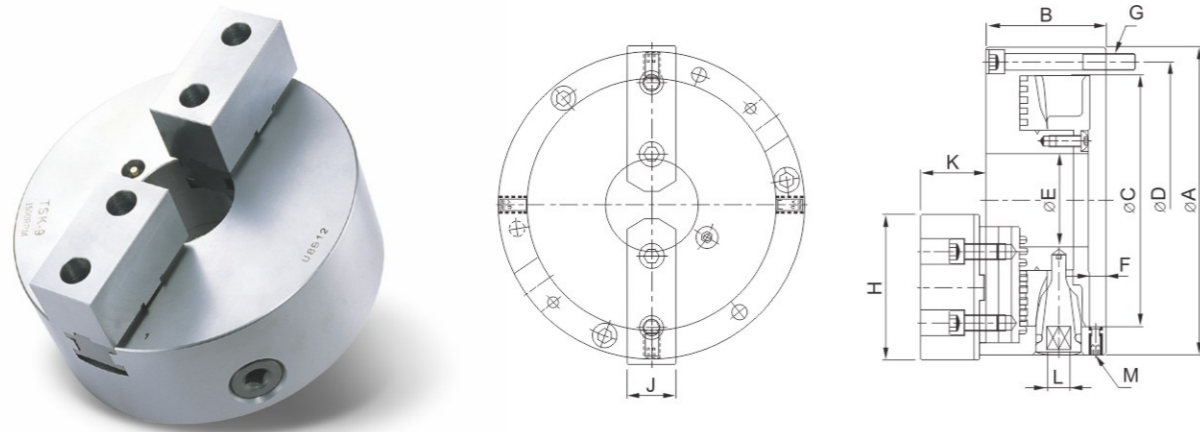

規格 / Specification

單位/UNIT:mm

型式 / 規格 MODEL/SPEC.	A	B	C	D	E	F	G	H	J	K	L	M	最高迴轉速 Max.Speed r.p.m.(min ⁻¹)	把握範圍 Max. Gripping Diameter		淨重 Weight (kg)
														外徑把握 O.D.Clamping	內徑把握 I.D.Clamping	
TKT-06	167	75.5	130	147	45	12	3-M10x1.5P	73	26	40.5	10	4-M10x1.5P	4000	ø9~ø160	ø60~ø150	10.4
TKT-07	193	85	155	172	58	12	3-M10x1.5P	95	31	49.5	11	4-M10x1.5P	3500	ø10~ø180	ø70~ø170	14.6
TKT-09	233	92	190	210	70	12.5	3-M12x1.75P	110	37	50	12	4-M10x1.5P	2900	ø12~ø220	ø80~ø210	22.4

強力型三爪可調式鋼殼夾頭

KT 3-JAW POWERFUL TYPE ADJUSTMENT STEEL BODY CHUCKS

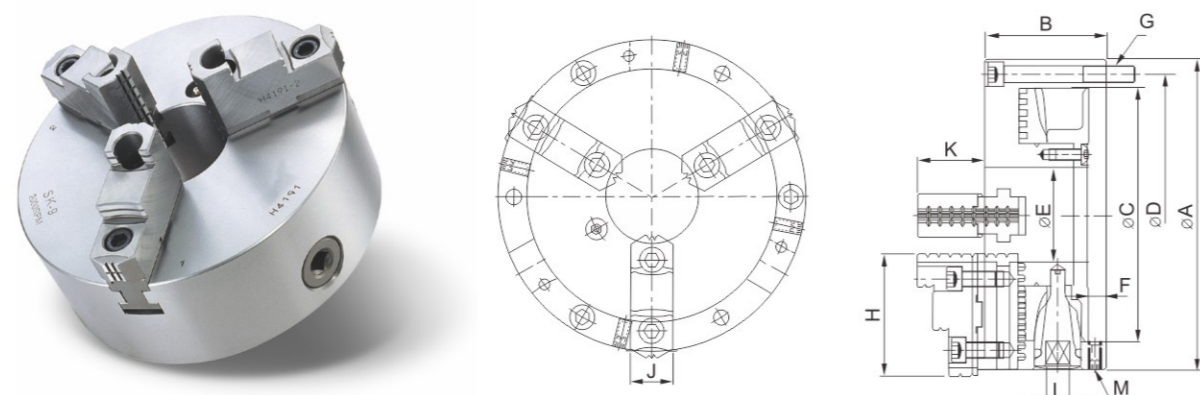

規格 / Specification

單位/UNIT:mm

型式 / 規格 MODEL/SPEC.	A	B	C	D	E	F	G	H	J	K	L	M	最高迴轉速 Max.Speed r.p.m.(min ⁻¹)	把握範圍 Max. Gripping Diameter		淨重 Weight (kg)
														外徑把握 O.D.Clamping	內徑把握 I.D.Clamping	
KT-06	167	75.5	130	147	45	12	3-M10x1.5P	68	26	40	10	4-M10x1.5P	4000	ø8~ø160	ø55~ø150	9.7
KT-07	193	85	155	172	58	12	3-M10x1.5P	82	28	43	11	4-M10x1.5P	3500	ø8~ø180	ø62~ø170	13.6
KT-09	233	92	190	210	70	12.5	3-M12x1.75P	93	32	51	12	4-M10x1.5P	2900	ø11~ø220	ø70~ø210	21.5
KT-10	275	98	230	250	89	12.5	3-M12x1.75P	102	35	54	12	4-M10x1.5P	2500	ø12~ø260	ø80~ø250	30.4
KT-12	310	111	260	285	105	14	3-M12x1.75P	118	40	58	14	4-M12x1.75P	2200	ø15~ø300	ø90~ø290	45.4

強力型四爪可調式鋼殼夾頭

FKT 4-JAW POWERFUL TYPE ADJUSTMENT STEEL BODY CHUCKS

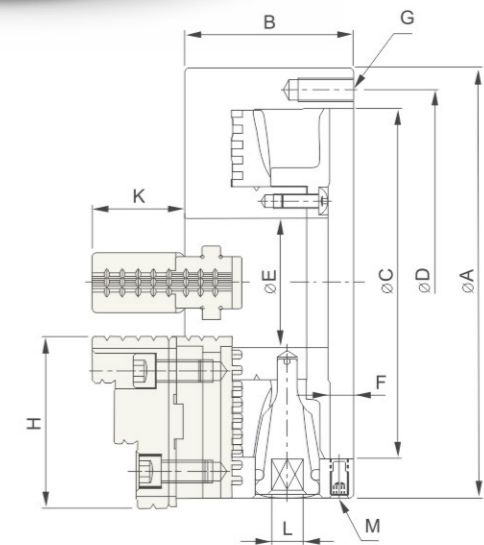
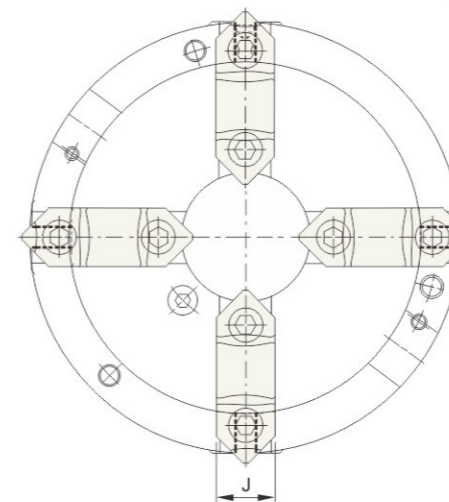

規格 / Specification

單位/UNIT:mm

型式 / 規格 MODEL/SPEC.	A	B	C	D	E	F	G	H	J	K	L	M	最高迴轉速 Max.Speed r.p.m.(min ⁻¹)	把握範圍 Max. Gripping Diameter		淨重 Weight (kg)
														外徑把握 O.D.Clamping	內徑把握 I.D.Clamping	
FKT-07	193	85	155	172	58	12	3-M10x1.5P	82	28	43	11	4-M10x1.5P	3500	ø8~ø180	ø62~ø170	14.1
FKT-09	233	92	190	210	70	12.5	3-M12x1.75P	93	32	51	12	4-M10x1.5P	2900	ø11~ø220	ø70~ø210	22
FKT-10	275	98	230	250	89	12.5	3-M12x1.75P	102	35	54	12	4-M10x1.5P	2500	ø12~ø260	ø80~ø250	33.5
FKT-12	310	111	260	285	105	14	3-M12x1.75P	118	40	58	14	4-M12x1.75P	2200	ø15~ø300	ø90~ø290	46.1

可調式普通型三爪鋼殼夾頭

DIN6350 3DACT 3-JAW ADJUSTMENT STEEL BODY SCROLL CHUCKS

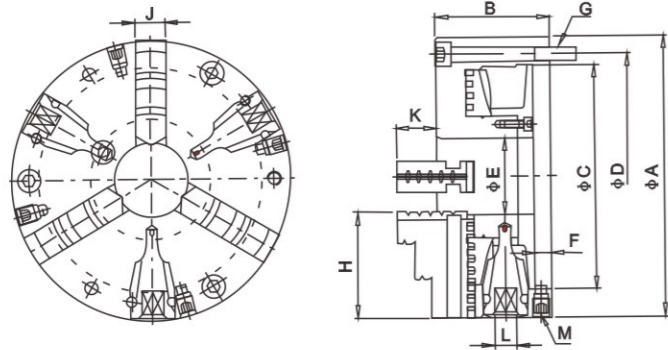

規格 / Specification

型式/規格 MODEL /SPEC.	A	B	C	D	E	G	F	H	J	K	M	L	最高迴轉速 Max.Speed r.p.m.(min ⁻¹)	把握範圍 Max 外徑把握 OD Clamping	Gripping Diameter 內徑把握 ID Clamping
3DACT-04	100	60	70	83	20	3-M8x1.25P	10	42	14	17	4-M8x1.25P	8	5200	Ø3-Ø95	Ø30-Ø83
3DACT-05	125	65	95	108	32	3-M8x1.25P	10.5	50	16	20	4-M10x1.5P	8	4800	Ø3-Ø160	Ø35-Ø111
3DACT-06	160	72.5	125	140	42	3-M10x1.5P	12	65	19	23	4-M12x1.75P	10	4200	Ø4-Ø160	Ø46-Ø155
3DACT-08	200	82.5	160	176	55	3-M10x1.5P	12	75	22	28	4-M12x1.75P	11	3500	Ø4-Ø197	Ø51-Ø184
3DACT-10	250	91	200	224	76	3-M12x1.75P	13	98	28	38.5	4-M12x1.75P	12	2600	Ø6-Ø267	Ø70-Ø252
3DACT-12	315	103	260	286	103	3-M16x2P	14	110	30	44.5	4-M12x1.75P	14	2200	Ø10-Ø325	Ø81-Ø308
3DACT-15	400	122	330	362	136	3-M16x2P	15	146	40	56	4-M12x1.75P	17	1600	Ø14-Ø428	Ø106-Ø410

單位/UNIT:mm

可調式普通型六爪鋼殼夾頭

DIN6350 6DACT 6-JAW ADJUSTMENT STEEL SCROLL CHUCKS

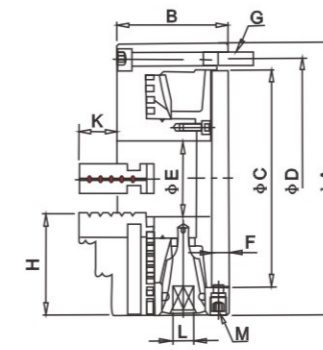
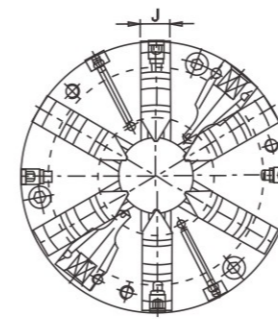

規格 / Specification

型式/規格 MODEL /SPEC.	A	B	C	D	E	G	F	H	J	K	M	最高迴轉速 Max.Speed r.p.m.(min ⁻¹)	把握範圍 Max 外徑把握 OD Clamping	Gripping Diameter 內徑把握 ID Clamping
6DACT-08	200	82.5	160	176	55	3-M10x1.5P	12	75	22	28	4-M12x1.75P	2900	Ø4-Ø183	Ø51-Ø170
6DACT-10	250	91	200	224	76	3-M12x1.75P	13	98	28	38.5	4-M12x1.75P	2200	Ø6-Ø249	Ø70-Ø233
6DACT-12	315	103	260	286	103	3-M16x2P	14	110	30	44.5	4-M12x1.75P	1800	Ø10-Ø305	Ø81-Ø288
6DACT-15	400	122	330	362	136	3-M16x2P	15	146	40	56	4-M12x1.75P	1300	Ø14-Ø406	Ø105-Ø387

單位/UNIT:mm

可調式普通型四爪鋼殼夾頭

DIN6350 4DACT 4-JAW ADJUSTMENT STEEL BODY SCROLL CHUCKS

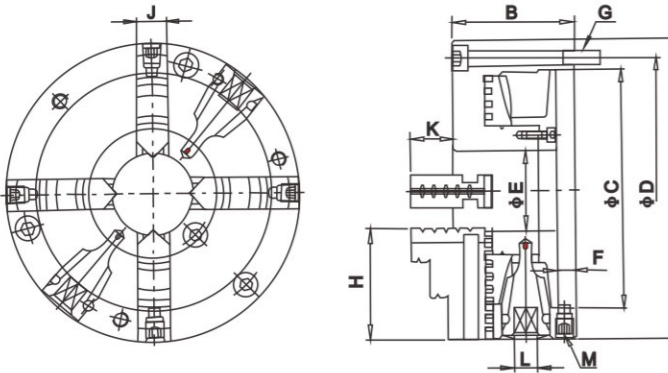

規格 / Specification

型式/規格 MODEL /SPEC.	A	B	C	D	E	G	F	H	J	K	M	L	最高迴轉速 Max.Speed r.p.m.(min ⁻¹)	把握範圍 Max 外徑把握 OD Clamping	Gripping Diameter 內徑把握 ID Clamping
4DACT-08	200	82.5	160	176	55	3-M10x1.5P	12	75	22	28	4-M12x1.75P	11	3500	Ø4-Ø197	Ø51-Ø184
4DACT-10	250	91	200	224	76	3-M12x1.75P	13	98	28	38.5	4-M12x1.75P	12	2600	Ø6-Ø267	Ø70-Ø252
4DACT-12	315	103	260	286	103	3-M16x2P	14	110	30	44.5	4-M12x1.75P	14	2200	Ø10-Ø325	Ø81-Ø308
4DACT-15	400	122	330	362	136	3-M16x2P	15	146	40	56	4-M12x1.75P	17	1600	Ø14-Ø428	Ø106-Ø410

單位/UNIT:mm

可調式強力型三爪鋼殼夾頭

DIN6350 3DAKT 3-JAW POWERFUL ADJUSTMENT STEEL BODY CHUCKS

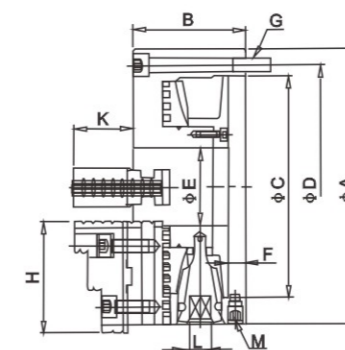

規格 / Specification

型式/規格 MODEL /SPEC.	A	B	C	D	E	G	F	H	J	K	M	最高迴轉速 Max.Speed r.p.m.(min ⁻¹)	把握範圍 Max 外徑把握 OD Clamping	Gripping Diameter 內徑把握 ID Clamping
3DAKT-05	125	65	95	108	32	3-M8x1.25P	10.5	57	24	36	4-M10x1.5P	4800	Ø3-Ø121	Ø44-Ø120
3DAKT-06	160	72.5	125	140	42	3-M10x1.5P	12	68	26	38.5	4-M12x1.75P	4200	Ø8-Ø169	Ø50-Ø158
3DAKT-08	200	82.5	160	176	55	3-M10x1.5P	12	82	28	43	4-M12x1.75P	3500	Ø8-Ø206	Ø58-Ø191
3DAKT-10	250	91	200	224	76	3-M12x1.75P	13	102	35	54.5	4-M12x1.75P	2600	Ø12-Ø266	Ø77-Ø250
3DAKT-12	315	103	260	286	103	3-M16x2P	14	117.5	40	56.5	4-M12x1.75P	2200	Ø15-Ø340	Ø85-Ø313
3DAKT-15	400	122	330	362	136	3-M16x2P	15	150	50	74.5	4-M12x1.75P	1600	Ø30-Ø440	Ø123-Ø416

單位/UNIT:mm

可調式強力型四爪鋼殼夾頭

DIN6350 4DAKT 4-JAW ADJUSTMENT STEEL SCROLL CHUCKS

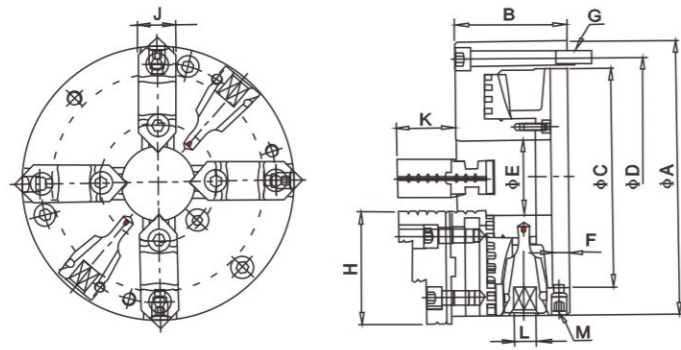

規格 / Specification

型式/規格 MODEL /SPEC.	A	B	C	D	E	G	F	H	J	K	M	L	最高迴轉速 Max.Speed r.p.m.(min ⁻¹)	把握範圍 Max 外徑把握 OD Clamping	Gripping Diameter 內徑把握 ID Clamping
4DAKT-08	200	82.5	160	176	55	3-M10x1.5P	12	82	28	43	4-M12x1.75P	11	3500	Ø8-Ø205	Ø59-Ø190
4DAKT-10	250	91	200	224	76	3-M12x1.75P	13	102	35	54.5	4-M12x1.75P	12	2600	Ø12-Ø265	Ø78-Ø249
4DAKT-12	315	103	260	286	103	3-M16x2P	14	117.5	40	56.5	4-M12x1.75P	14	2200	Ø15-Ø323	Ø86-Ø296
4DAKT-15	400	122	330	362	136	3-M16x2P	15	150	50	74.5	4-M12x1.75P	17	1600	Ø30-Ø419	Ø124-Ø396

單位/UNIT:mm

可調式強力型六爪鋼殼夾頭

DIN6350 6DAKT 6-JAW ADJUSTMENT STEEL SCROLL CHUCKS

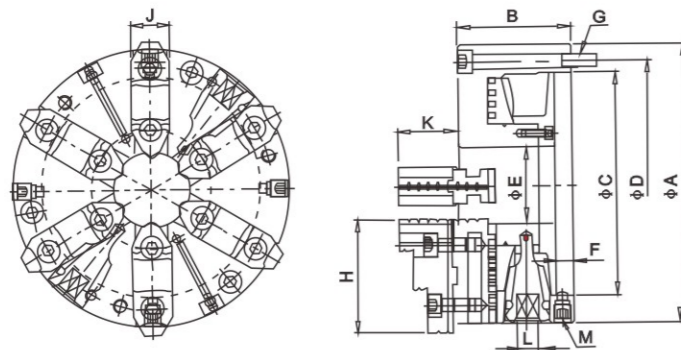

規格 / Specification

型式/規格 MODEL /SPEC.	A	B	C	D	E	G	F	H	J	K	M	最高迴轉速 Max.Speed r.p.m.(min ⁻¹)	把握範圍 Max 外徑把握 OD Clamping	Gripping Diameter 內徑把握 ID Clamping
6DAKT-08	200	82.5	160	176	55	3-M10x1.5P	12	82	28	43	11	2900	Ø17-Ø193	Ø67-Ø178
6DAKT-10	250	91	200	224	76	3-M12x1.75P	13	102	35	54.5	12	2200	Ø19-Ø248	Ø84-Ø232
6DAKT-12	315	103	260	286	103	3-M16x2P	14	117.5	40	56.5	14	1800	Ø23-Ø323	Ø93-Ø296
6DAKT-15	400	122	330	362	136	3-M16x2P	15	150	50	74.5	17	1300	Ø30-Ø419	Ø124-Ø396

單位/UNIT:mm

SC10二爪自定心卡盤

SC10 SERIES TWO-JAW SELF-CENTERING CHUCKS

尺寸為500及630的有T形槽
Size 500,630 with T-slots.

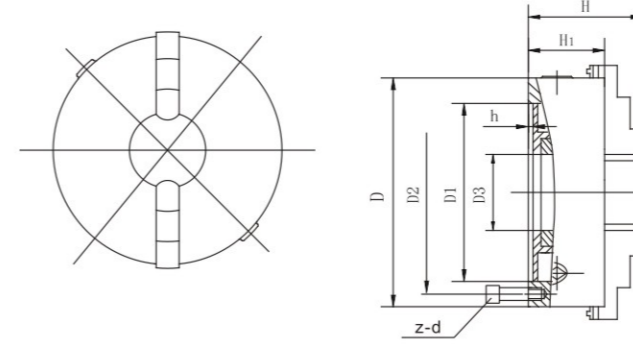

二爪自定心卡盤適用於各種异形工件的加工
Used for machining all types of workpiece of irregular shapes.

標準配件: Standard accessories:

- ◎ 一套正爪 1 set of outside hard solid jaws
- ◎ 一套反爪 1 set of inside hard solid jaws
- ◎ 一個扳手 1 wrench
- ◎ 一套螺絲 1 set of mounting screws.

可選配件: Optional accessories:

- ◎ 一套滑座 1 set of hard master jaws
- ◎ 一套軟上爪 1 set of top soft jaws
- ◎ 一套分離爪 (滑座+軟上爪) 1 set of soft 2-piece jaws (hard master jaw + top soft jaw)

卡盤尺寸 CHUCK SIZE	型號 Code No
80	SC10-80S
100	SC10-100S
125	SC10-125S
160	SC10-160S
200	SC10-200S
250	SC10-250S
315	SC10-315S
400	SC10-400S

規格 / Specification

型式/規格 MODEL /SPEC	卡盤尺寸 Chuck Size	D1	D2	D3	H1	h	Z	D	H
SC10-80	80	55	66	16	50	4	3	M6	66.5
SC10-100	100	72	84	22	55	3	3	M8	74.5
SC10-125	125	95	108	30	58	4	3	M8	84.5
SC10-160	160	130	142	45	65	5	3	M8	94
SC10-200	200	165	180	65	75	6	3	M10	109
SC10-250	250	206	226	80	80	6	3	M12	120
SC10-315	315	260	285	100	90	6	3	M16	147.5
SC10-400	400	340	368	130	112.5	6	3	M16	173.5

單位/UNIT:mm

型式/規格 MODEL /SPEC	夾持範圍 Max.Gripping Dia Internal Jaws	最高轉速 Max RPM	最大靜夾持力 Max. gripping force KN	毛重 G.W. KG
SC10-80	2-70	4000	8	1.7
SC10-100	2-90	3500	10	2.8
SC10-125	2.5-125	3000	15	4.7
SC10-160	3-160	2500	22	8
SC10-200	4-200	2000	28	15
SC10-250	6-250	1600	32	25
SC10-315	10-315	1200	36	45
SC10-400	15-400	1000	40	69

SC11三爪自定心卡盤

SC11 SERIES THREE-JAW SELF-CENTERING CHUCKS

三爪自定心卡盤適用於高精度的加工過程 Used when high accuracy of machining is needed.
另有其他短錐形式的卡盤，如A型、C型、D型 Other short taper mounting type like A/C/D is available.

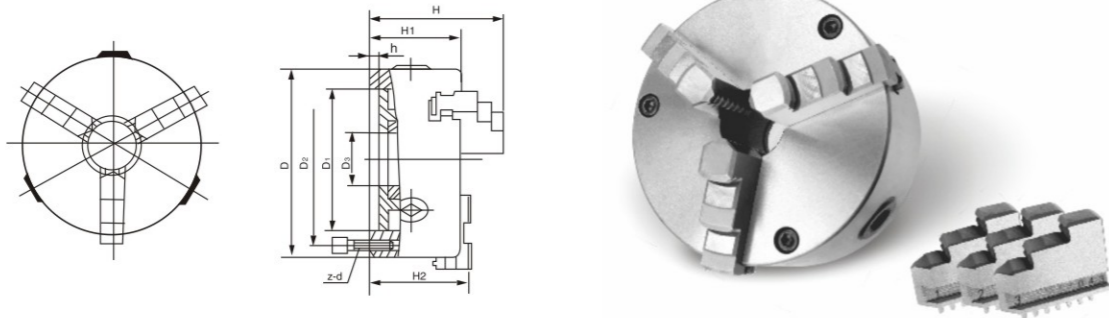

- | | |
|--|---|
| 標準配件: Standard accessories: | 可選配件: Optional accessories: |
| <ul style="list-style-type: none"> ◎ 一套正爪 1 set of outside hard solid jaws ◎ 一套反爪 1 set of inside hard solid jaws ◎ 一個扳手 1 wrench ◎ 一套螺絲 1 set of mounting screws. | <ul style="list-style-type: none"> ◎ 一套滑座 1 set of hard master jaws ◎ 一套軟上爪 1 set of top soft jaws ◎ 一套分離爪 (滑座+軟上爪) 1 set of soft 2-piece jaws(hard master jaw + top soft jaw) |

規格 / Specification

單位/UNIT:mm

型號 MODEL	卡盤尺寸 Chuck Size	D1	D2	D3	H	H1	h	z-d	最大扭矩Nm Max.torque	最高轉速 Max.RPM	淨重 N.W. Kg
SC11-80	80	55	66	16	66.5	50	4	3-M6	40	4000	1.9
SC11-100	100	72	84	22	74.5	55	3	3-M8	60	3500	3.2
SC11-125	125	95	108	30	84.5	58	4	3-M8	100	3000	5
SC11-130	130	100	115	30	86.5	60	5	3-M8	100	3000	5.6
SC11-160	160	130	142	45	94	65	5	3-M8	160	2500	8.8
SC11-165	165	130	145	45	94	65	5	3-M8	160	2500	9.5
SC11-190	190	155	172	55	105	75	5	3-M10	250	2000	13.8
SC11-200	200	165	180	65	109	75	5	3-M10	250	2000	15.5
SC11-230	230	190	210	70	120	80	6	3-M12	250	2000	16.5
SC11-240	240	195	215	70	120	80	8	3-M12	320	1600	26
SC11-250	250	206	226	80	120	80	5	3-M12	320	1600	27.5
SC11-315	315	260	285	100	147.5	90	6	3-M16	400	1200	47
SC11-320	320	270	290	100	147.5	90	6	3-M16	400	1200	47.5
SC11-325	325	272	296	100	147.5	90	6	3-M16	400	1200	49
SC11-380	380	325	350	135	155.7	98	6	3-M16	500	1000	68
SC11-400	400	340	368	130	173.5	100	6	3-M16	500	1000	73
SC11-500	500	440	465	210	202	115	6	6-M16	630	800	121
SC11-630	630	560	595	270	218	133.5	7	6-M16	800	800	200

SC12系列四爪自定心卡盤

SC12 SERIES FOUR-JAW SELF-CENTERING CHUCKS

四爪自定心卡盤適用於高精度的加工過程 Used when high accuracy of machining is needed.
另有其他短錐形式的卡盤，如A型、C型、D型 Other short taper mounting type like A/C/D is available.

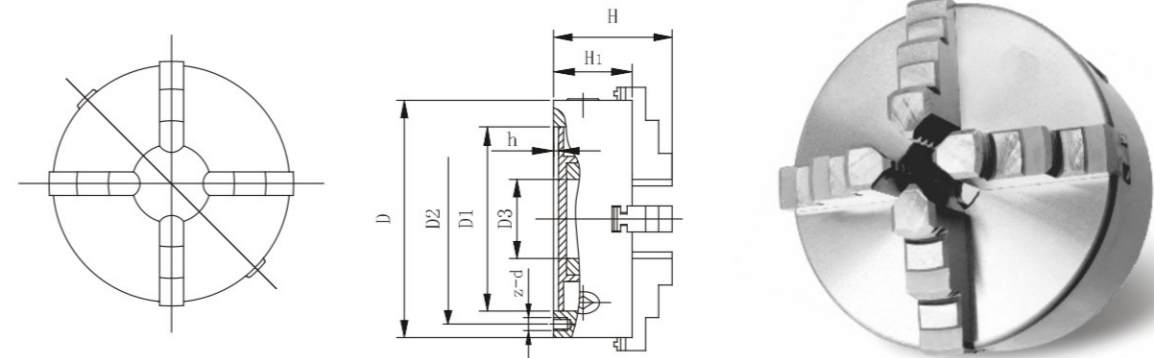

- | | |
|--|---|
| 標準配件: Standard accessories: | 可選配件: Optional accessories: |
| <ul style="list-style-type: none"> ◎ 一套正爪 1 set of outside hard solid jaws ◎ 一套反爪 1 set of inside hard solid jaws ◎ 一個扳手 1 wrench ◎ 一套螺絲 1 set of mounting screws. | <ul style="list-style-type: none"> ◎ 一套滑座 1 set of hard master jaws ◎ 一套軟上爪 1 set of top soft jaws ◎ 一套分離爪 (滑座+軟上爪) 1 set of soft 2-piece jaws(hard master jaw + top soft jaw) |

規格 / Specification

單位/UNIT:mm

型號 MODEL	卡盤尺寸 Chuck Size	D1	D2	D3	H	H1	h	z-d	淨重 N.W. Kg
SC12-80	80	55	66	16	66.5	50	4	3-M6	2
SC12-100	100	72	84	22	74.5	53.5	3	3-M8	3
SC12-125	125	95	108	30	84.5	58	4	3-M8	5
SC12-130	130	100	115	30	86.5	60	5	3-M8	5.6
SC12-160	160	130	142	45	94	65	5	3-M8	8.8
SC12-165	165	130	145	45	94	65	5	3-M8	9.8
SC12-190	190	155	172	55	105	75	5	3-M10	13.8
SC12-200	200	165	180	65	109	75	5	3-M10	15.5
SC12-240	240	195	215	70	120	80	8	3-M12	25
SC12-250	250	206	226	80	120	80	5	3-M12	26
SC12-315	315	260	285	100	147.5	90	6	3-M16	50
SC12-320	320	270	290	100	147.5	90	6	3-M16	53
SC12-325	325	272	296	100	147.5	90	6	3-M16	66
SC12-380	380	325	350	130	173.5	100	6	3-M16	82
SC12-400	400	340	368	130	173.5	100	6	3-M16	85
SC12-500	500	440	465	210	202	115	6	6-M16	119
SC12-630	630	560	595	260	220.5	135	6	6-M16	185

SC72系列四爪單動卡盤

SC72 SERIES 4 JAW INDEPENDENT MOVEMENT CHUCKS

另有其他短錐形式的卡盤，如A型、C型、D型 Other short taper mounting type like A/C/D is available.

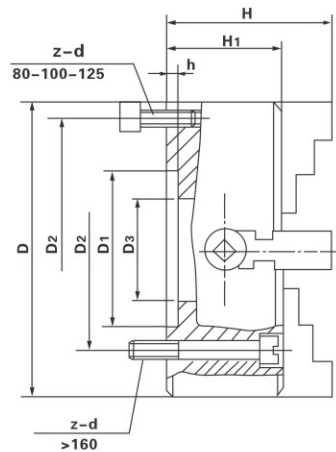

- 標準配件: Standard accessories:
- ⊙ 一套卡爪 1 set of hard solid jaws
 - ⊙ 一個扳手 1 wrench
 - ⊙ 一套螺絲 1 set of mounting screws.

規格 / Specification

單位/UNIT:mm

型號 MODEL	卡盤尺寸 Chuck Size	Size D Inch	D1	D2	D3	H	H1	h	z-d
SC72-80	80	3	55	66	22	58	42	3.5	4-M6
SC72-100	100	4	72	84	25	77	54	4	4-M8
SC72-125	125	5	95	108	30	78	56	4.5	4-M8
SC72-160	160	6	65	95	45	96.5	65	5	4-M10
SC72-160A	160	6	53	71	45	96.5	65	5	4-M10
SC72-160T	160	6	130	145	40	96.5	65	5	4-M10
SC72-200	200	8	125	104.8	50	110	75	6	4-M10
SC72-200A	200	8	75	95	56	110	75	6	4-M10
SC72-250	250	10	100	120	65	117.5	82	6	4-M12
SC72-250A	250	10	110	130	75	115.5	80	6	4-M12
SC72-300	300	12	152	130	75	128.5	85	6	4-M12
SC72-315	315	12	140	165	95	134	90	6	4-M16
SC72-320	320	13	140	165	95	134	90	6	4-M16
SC72-350	350	14	130	168	80	145	95	8	4-M16
SC72-400	400	16	160	185	125	143	95	8	4-M16
SC72-450	450	18	180	205	140	147	100	8	4-M16
SC72-500	500	20	200	236	160	161	106	8	4-M20
SC72-630	630	25	220	258	180	180	115	10	4-M20
SC72-800	800	32	250	300	210	210	135	12	8-M20
SC72-1000	1000	40	320	370	260	241	150	15	8-M20
SC72-1000A	1000	40	285	330	280	241	150	75	8-M20
SC72-1250	1250	50	400	500	305	256	165	15	8-M20
SC72-1400	1400	55	400	500	305	246	155	15	8-M20
SC72-1600	1600	63	420	520	320	266	175	18	8-M24
SC72-2000	2000	80	450	560	350	290	190	20	8-M30